



C50



TECHNICAL DATA [approx.]

C50

Length over all	15,43 m	50,62 ft
Length over all incl. bowsprit	15,98 m	52,42 ft
Length hull	14,99 m	49,17 ft
Length waterline	14,28 m	46,85 ft
Beam of hull	5,00 m	16,40 ft
Draught standard	2,30 m	7,54 ft
Draught option	1,85 m	6,06 ft
Ballast standard	4.206 kg	9.272 lb
Ballast option	4.363 kg	9.618 lb
Displacement standard	15.423 kg	34.001 lb
Displacement option	16.568 kg	36.526 lb
Engine [standard]	58,8 kW / 80 PS	58,8 kW / 80 hp
Engine [standard]	Yanmar 4JH80	Yanmar 4JH80
Fuel tank [approx.]	244 L	64 gal
Water tank [approx.]	620 L	162 gal
Sail area total [standard]	131,2 m ²	1412,2 sq.ft
Mainsail [standard]	75,2 m ²	809,4 sq.ft
Mainsail [furling]	61,5 m ²	661,9 sq.ft
Jib	56,0 m ²	602,7 sq.ft
Genoa	63,5 m ²	683,5 sq.ft
Gennaker	194,0 m ²	2088,2 sq.ft
Code 0	105,0 m ²	1130,2 sq.ft
Mast length [max.] from waterline excl. Windex	23,25 m	76,28
I	20,00 m	65,61 ft
J	5,77 m	18,93 ft
P	19,25 m	63,15 ft
E	6,66 m	21,85 ft
Cabins	3/5	3/5
Head	3/4	3/4
CE category	A12 / B16 / C18	A12 / B16 / C18
Design	Cossutti Yacht Design	

BASE PRICE EX WORKS (EXCL. VAT) - C50 HOLIDAY 372.000,00 €

BASE PRICE EX WORKS (EXCL. VAT) - C50 STYLE 387.500,00 €

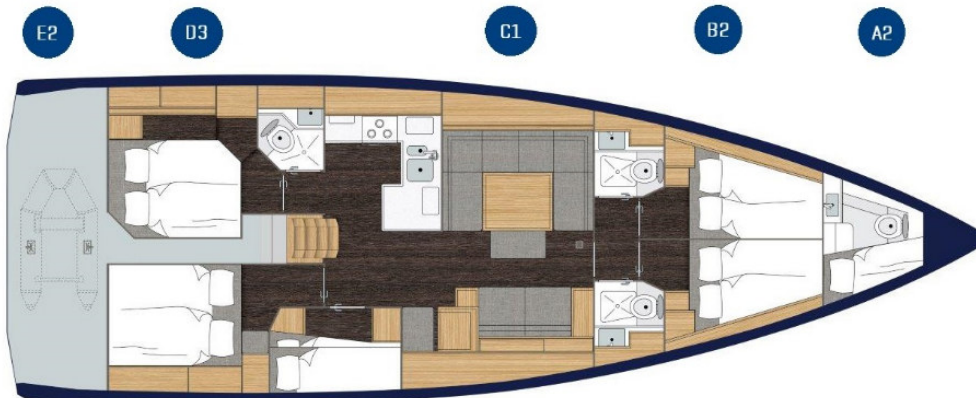
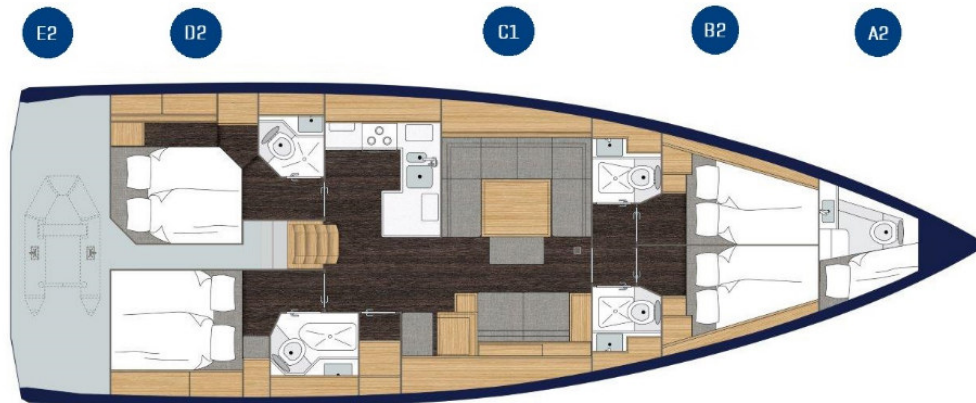
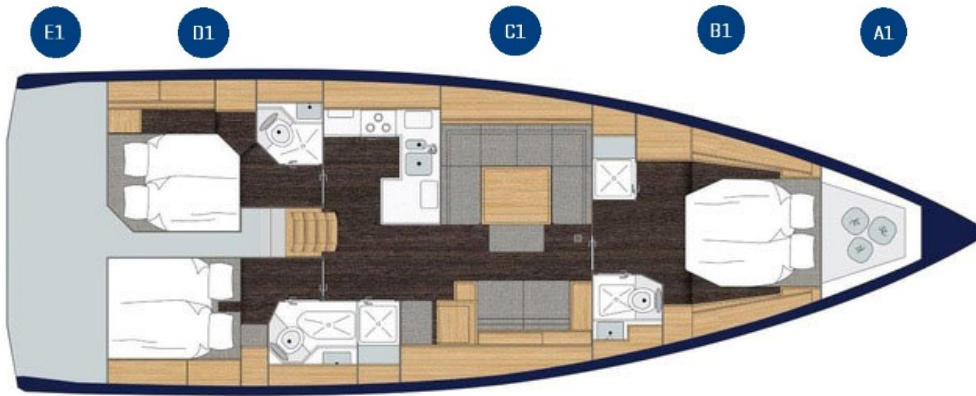

TRIM LEVEL EQUIPMENT	HOLIDAY	STYLE	C50
INTERIOR STYLING			
Headboard, fabric covered, in forward cabin (B1)		■	
Bed frames, fabric covered, in front and aft cabins		■	
Ceiling panels, fabric covered, in salon		■	
Chart table, leather covered		■	
Handrails, stainless steel, leather covered		■	
COCKPIT & DECK			
Rope storage boxes, at helm position		■	
INTERIOR EQUIPMENT			
Reading lights incl. USB charger, salon and cabins		■	
Handrail on ceiling in stainless steel with leather cover		■	

OPTIONSPAKETE	HOLIDAY	STYLE	Price excl. VAT	C50
SAIL READY PACK "HOLIDAY" [HP]				
PACKAGE CONTENTS	○	—	16.250,00 €	<input type="checkbox"/>
Battery extension, additional service battery, 2 x battery 95 Ah / 12 V, AGM incl. charger 60 A [instead of charger 40 A] Guard rail exit, both sides Anchor windlass, electrical Anchor, 25 kg, incl. chain [10 mm, 75 m], galvanized Courtesy lights in salon Curtains for coachroof and hull windows Blinds incl. mosquito nets for hatches in salon and cabins Deck vents, 2 x, on deck hatches				
LED lights in salon and cabins Mooring kit [8 fenders and 4 mooring lines] Reading lights incl. USB charger, salon and cabins Handrail on ceiling in stainless steel Rope storage boxes, bb and stb at helm position Stainless steel bow protection Cockpit shower with cold and warm water				
UPGRADES SAIL READY PACK "HOLIDAY" [HP]				
Bow thruster, tunnel, incl. additional battery 2 x 95 Ah / 12 V, AGM	○	—	8.190,00 €	<input type="checkbox"/>
Anchor, 25 kg, incl. chain [10 mm, 75 m] stainless steel	○	—	4.920,00 €	<input type="checkbox"/>
Anchor windlass with capstans	○	—	1.350,00 €	<input type="checkbox"/>
SAIL READY PACK "STYLE" [SP]				
PACKAGE CONTENTS	—	○	28.750,00 €	<input type="checkbox"/>
Bow thruster, tunnel, incl. additional battery 2 x 95 Ah / 12 V, AGM Teak on cockpit bottom Battery extension, additional service battery, 2 x battery 95 Ah / 12 V, AGM incl. charger 60 A [instead of charger 40 A] Guard rail exit, both sides Anchor windlass, electrical Anchor, 25 kg, incl. chain [10 mm, 75 m], galvanized Courtesy lights in salon and in cockpit Curtains for coachroof and hull windows				
Blinds incl. mosquito nets for hatches in salon and cabins Deck vents, 2 x, on deck hatches LED lights in salon and cabins Mooring kit [8 fenders and 4 mooring lines] Ambient lights in salon and cabins, dimmable Extractor hood in galley Cockpit shower with cold and warm water				
UPGRADES SAIL READY PACK "STYLE" [SP]				
Bow thruster, retractable, incl. additional battery 2 x 95 Ah / 12 V, AGM	—	○	6.780,00 €	<input type="checkbox"/>
Esthec on cockpit bottom	—	○	800,00 €	<input type="checkbox"/>
Anchor, 25 kg, incl. chain [10 mm, 75 m] stainless steel	—	○	4.920,00 €	<input type="checkbox"/>
Anchor windlass with capstans	—	○	1.350,00 €	<input type="checkbox"/>
NAVIGATIONSPAKETE				
NAVIGATION "BASIC" PACKAGE	○	—	12.110,00 €	<input type="checkbox"/>
Instrument console [1 x per helm station] Display, 2 x B&G Triton ² digital displays in cockpit; B&G Wind vane; DST800 Transducer for speed, depth and temperature Multi function display, B&G Zeus ³ S 9" with integrated GoFree™ Wi-Fi; all- weather touch screen and expanded keypad				
VHF, B&G V60 with integrated AIS Receiver at chart table Autopilot B&G, incl. compass Autopilot B&G, control unit at helmstation stb Autopilot B&G, wireless remote control WR10				
NAVIGATION "ADVANCED" PACKAGE				
Instrument console [1 x per helm station] Display, 2 x B&G Triton ² digital displays in cockpit; B&G Wind vane; DST800 Transducer for speed, depth and temperature Multi function display, 2 x B&G Zeus ³ S 9" with integrated GoFree™ Wi-Fi; all- weather touch screen and expanded keypad, one per helm station	○	○	16.060,00 €	<input type="checkbox"/>
VHF, B&G V60 with integrated AIS Receiver at chart table VHF, B&G H60 wireless handset Autopilot B&G, incl. compass Autopilot B&G, control unit at helmstation stb Autopilot B&G, wireless remote control WR10				
NAVIGATION "PREMIUM" PACKAGE				
Instrument console [1 x per helm station] Display, 2 x B&G H5000 graphic displays [1 x per helmstation]; B&G Wind vane; DST800 Transducer for speed, depth and temperature Multi function display, 2 x B&G Zeus ³ S 12" with integrated GoFree™ Wi-Fi; all- weather touch screen and expanded keypad, one per helmstation NMEA engine information interface for chart plotter	—	○	26.570,00 €	<input type="checkbox"/>
VHF, B&G V60 with integrated AIS Receiver at chart table VHF, B&G H60 wireless handset Autopilot B&G, incl. compass Autopilot B&G, H5000 control unit [1 x per helmstation] Autopilot B&G, Hydra computer Autopilot B&G, wireless remote control WR10 Wifi router Locomarine, Micro 5s				
UPGRADES NAVIGATION PACKAGE				
Multi function display, B&G Zeus ³ S 9" with integrated GoFree™ Wi-Fi; all-weather touch screen and expanded keypad, at chart table	○	○	3.630,00 €	<input type="checkbox"/>
Radar B&G Halo 20+	○	○	3.840,00 €	<input type="checkbox"/>
Depth sounder, B&G ForwardScan	—	○	1.760,00 €	<input type="checkbox"/>
AIS transponder, B&G NAIS-500 class B transponder	○	○	1.530,00 €	<input type="checkbox"/>
NMEA engine information interface for chart plotter [included in Navigation "PREMIUM" Package]	○	○	1.280,00 €	<input type="checkbox"/>
ENTERTAINMENT PACKAGE				
PACKAGE CONTENTS	○	○	2.980,00 €	<input type="checkbox"/>
Radio entertainment system Fusion MS-RA770 Apollo Marine with DAB+ and 2 speakers in salon				
Fusion ERX400 Apollo remote control with 2 speakers in cockpit				
UPGRADES ENTERTAINMENT PACKAGES				
ENTERTAINMENT PACKAGE "OWNER"				
Radio entertainment system Fusion MS-RA210 with DAB+ and 2 speakers in foreship cabin [only with B1]	—	○	1.230,00 €	<input type="checkbox"/>
TV preparation in salon, incl. TV lift system	○	○	1.990,00 €	<input type="checkbox"/>

INDIVIDUAL OPTIONS	HOLIDAY	STYLE	Price excl. VAT	C50
HULL / KEEL				
STANDARD				
Hull in sandwich construction				Keel, L-shape, cast iron, draft 2,30 m
OPTIONS				
Hull colour, white	■	■	Standard	<input type="checkbox"/>
Hull colour silk grey with hull stripe white	○	○	5.670,00 €	<input type="checkbox"/>
Hull stripe, dark blue	■	○	1.390,00 €	<input type="checkbox"/>
Hull stripe, silk grey	○	■	1.390,00 €	<input type="checkbox"/>
Hull stripe, dark grey	○	○	1.390,00 €	<input type="checkbox"/>
Hull stripe, jet black	○	○	1.390,00 €	<input type="checkbox"/>
Keel, L-shape, cast iron, draft 1,85 m	○	○	3.580,00 €	<input type="checkbox"/>
PROPULSION & STEERING SYSTEM				
STANDARD				
Diesel engine, 59 kW / 80 hp, sail drive				Twin wheel steering system
3 blade fixed propeller				GRP single rudder with aluminum stock
Engine throttle, mechanical, mounted on helm station starboard				Steering wheel, stainless steel with leather cover
OPTIONS				
Propeller, folding, 3 blades	○	○	2.580,00 €	<input type="checkbox"/>
Stern thruster incl. 2 x 95 Ah battery, retractable (only with bow thruster retractable)	—	○	15.750,00 €	<input type="checkbox"/>
Steering wheel, composite, black or white	○	○	1.870,00 €	<input type="checkbox"/>
Steering wheels covers	—	○	670,00 €	<input type="checkbox"/>
STANDING AND RUNNING GEAR				
STANDARD				
Sportmast, deck stepped, 2 spreader, aluminum				Midboom sheeting system
Jib furling system, above deck, manual				Elvström Cruisetech Dacron - Mainsail, short battened with 2 reefs - self tacking jib, no battens
Rodkicker				Halyard winches, 2 x, size 55, manual
Backstay adjuster, mechanical				
OPTIONS SPORTMAST				
Elvström Cruisetech Dacron - Mainsail, full battened with 2 reefs and MDS slider (replacing standard main sail)	○	○	1.500,00 €	<input type="checkbox"/>
Elvström Duratech Dacron - Mainsail, full battened with 2 reefs and MDS slider- self tacking jib, no battens	○	—	10.530,00 €	<input type="checkbox"/>
Elvström Sporttech laminate - Mainsail, full battened with 2 reefs and MDS slider- self tacking jib, vertical battened	○	○	13.930,00 €	<input type="checkbox"/>
Lazy bag with lazy jacks for mainsail	○	○	1.730,00 €	<input type="checkbox"/>
OPTIONS FURLING MAST				
Furling mast on deck stepped 2 spreader, aluminum incl. upgrade to Cruisetech Dacron furling mainsail	○	○	4.040,00 €	<input type="checkbox"/>
Intracoastal Waterway Rigging: Short-mast and mainsail furling system incl. upgrade to Cruisetech Dacron furling mainsail	○	○	4.990,00 €	<input type="checkbox"/>
Elvström Duratech Dacron - furling mainsail, no battens - self tacking jib, no battens	○	—	9.050,00 €	<input type="checkbox"/>
Elvström Sporttech laminate - furling mainsail, full battened - self-tacking jib with vertical battens	○	○	13.820,00 €	<input type="checkbox"/>
OPTIONS STANDING AND RUNNING GEAR				
Elvström genoa 106% - Cruisetech Dacron (only with genoa tracks)	○	○	5.200,00 €	<input type="checkbox"/>
Elvström genoa 106% - Duratech (only with genoa tracks)	○	—	5.890,00 €	<input type="checkbox"/>
Elvström genoa 106% - Sporttech (only with genoa tracks)	○	○	8.050,00 €	<input type="checkbox"/>
Genoa tracks with pin stop cars	○	○	1.800,00 €	<input type="checkbox"/>
Elvström gennaker incl. snuffer and gennaker gear (halyard, sheets, blocks, halyard clutch and pad eye)	○	○	7.570,00 €	<input type="checkbox"/>
Elvström Code 0 incl. Selden CX furling system and gear (halyard, sheets, blocks, halyard clutch and pad eye for code 0 tack / only with bowsprit)	○	○	8.810,00 €	<input type="checkbox"/>
Mast step	○	○	740,00 €	<input type="checkbox"/>
Spreader lights, 4 pcs.	—	○	1.660,00 €	<input type="checkbox"/>
GRP bowsprit (black or white / recommended for gennaker and code 0)	—	○	3.640,00 €	<input type="checkbox"/>
OPTIONS WINCHES				
Halyard winches, 2 x, size 55, electrical	○	○	6.950,00 €	<input type="checkbox"/>
Genoa/gennaker/code0 winches, 2 x, size 55, manual	○	○	3.440,00 €	<input type="checkbox"/>
Genoa/gennaker/code0 winches, 2 x, size 55, electrical	—	○	6.950,00 €	<input type="checkbox"/>
DECK FLOORING				
STANDARD				
Teak on cockpit benches and bathing platform				
OPTIONS				
Teak on cockpit bottom	○	○	5.220,00 €	<input type="checkbox"/> SP
Teak on side decks	○	○	19.710,00 €	<input type="checkbox"/>
Teak on coachroof	—	○	7.330,00 €	<input type="checkbox"/>
Esthec on cockpit benches and bathing platform	○	○	690,00 €	<input type="checkbox"/>
Esthec on cockpit bottom	○	○	5.650,00 €	<input type="checkbox"/>
Esthec on side decks	○	○	19.750,00 €	<input type="checkbox"/>
Esthec on coachroof	—	○	7.300,00 €	<input type="checkbox"/>

INDIVIDUAL OPTIONS	HOLIDAY	STYLE	Price excl. VAT	C50
COCKPIT & DECK				
STANDARD				
Deck in sandwich construction, cockpit floor, side decks and coach roof with non-slip structure Deck flush hatches				
			Cockpit table with small storage, 2 x, fix Bow fitting with anchor roller, stainless steel Mooring cleats, 6 x, stainless steel, fix	
OPTIONS COCKPIT & DECK				
Cockpit table with small storage, 2 x, electrical, lowerable to sun bathing area	—	○	4.490,00 €	<input type="checkbox"/>
Drawer fridge incl. compressor at wet bar, 20 L [only in combination with E2 and BBQ]	○	○	1.690,00 €	<input type="checkbox"/>
BBQ [gas] with sink and water tap in wet bar [only in combination with E2]	○	○	2.620,00 €	<input type="checkbox"/>
Guard rail exit, both sides	○	○	1.310,00 €	<input type="checkbox"/> HP, SP
Mooring cleats, 6 x, aluminum, retractable	—	○	4.160,00 €	<input type="checkbox"/>
Stainless steel bow protection	○	○	570,00 €	<input type="checkbox"/> HP
OPTIONS COCKPIT UPHOLSTERY				
Cockpit cushions incl. backrests	—	○	3.700,00 €	<input type="checkbox"/>
Cockpit cushions for lowerable tables	—	○	570,00 €	<input type="checkbox"/>
Cockpit cushions	○	○	2.150,00 €	<input type="checkbox"/>
Sun bed cushions on coachroof incl. headrest and cup holders	○	○	2.040,00 €	<input type="checkbox"/>
Sun bed cushions on foredeck incl. headrest and cup holders	○	○	2.150,00 €	<input type="checkbox"/>
OPTIONS HOODS				
Bimini top	○	○	4.710,00 €	<input type="checkbox"/>
Sprayhood with handhold	○	○	2.990,00 €	<input type="checkbox"/>
Cockpit tables cover	—	○	700,00 €	<input type="checkbox"/>
BATHING PLATFORM				
STANDARD				
Bathing platform, electric				
OPTIONS				
Wireless remote control for bathing platform	○	○	1.580,00 €	<input type="checkbox"/>
12 V air compressor at transom for dinghy or toys [only with E2 Layout]	○	○	920,00 €	<input type="checkbox"/>

INTERIOR LAYOUT				
STANDARD				
A1: Sail locker B1: Queen size "island" double berth, storage, separate head and shower stall C1: Salon incl. L shaped galley, dining area on port, lounge area and chart table on stb				
			D3: 2 twin cabins aft incl. head and utility room on stb E1: Storage space for toys and equipment under cockpit, access via cockpit floor hatch Companion way with washboard and sliding hatch in acrylic glass, lockable Salon dining table	
OPTIONS				
A2: Crew cabin with sink, toilet and storage space	○	○	7.390,00 €	<input type="checkbox"/>
B2: 2 Forward cabins, each cabin with double bed and storage, flex bulkhead system, 2 heads	○	○	5.060,00 €	<input type="checkbox"/>
D1: 2 Aft cabins, incl. head with separate shower stall on stb	○	○	3.210,00 €	<input type="checkbox"/>
D2: 2 Aft cabins, incl. bunk bed cabin on stb	○	○	2.670,00 €	<input type="checkbox"/>
E2: Dinghy garage with integrated transom bench and storage/wetbar [for wetbar; option BBQ/watertap]	○	○	4.470,00 €	<input type="checkbox"/>
Salon table, lowerable, electrical, convertible into double berth incl. cushion, electrical	○	○	2.710,00 €	<input type="checkbox"/>

INTERIOR STYLING				
STANDARD				
Wood color, Mahogany Floor, Elm Worktop in galley, laminated, "Brown stone"				
			Upholstery "Vela" in salon Standard mattresses for all berths	
OPTIONS STYLING				
Wood color, Mahogany	■	■	Standard	<input type="checkbox"/>
Wood color, American Walnut	○	○	6.470,00 €	<input type="checkbox"/>
Wood color, Nordic Oak	○	○	7.160,00 €	<input type="checkbox"/>
Floor, Elm	■	■	Standard	<input type="checkbox"/>
Floor, Wenge	○	○	980,00 €	<input type="checkbox"/>
Floor, Ocean Line	○	○	1.410,00 €	<input type="checkbox"/>
Worktop in galley, laminated, "Pure white stone"	○	—	740,00 €	<input type="checkbox"/>
Worktop in galley, solid worktop "Gravel"	—	○	2.260,00 €	<input type="checkbox"/>
Worktop in galley, solid worktop "Chrispy Milk"	—	○	2.470,00 €	<input type="checkbox"/>
OPTIONS UPHOLSTERY				
Upholstery "Opus" in salon, artificial leather	○	○	1.530,00 €	<input type="checkbox"/>
Upholstery "Savoy" in salon, leather	—	○	6.080,00 €	<input type="checkbox"/>
Cold foam mattress with memory top for all berths 3 cabins	○	○	3.520,00 €	<input type="checkbox"/>
Cold foam mattress with memory top for all berths 4 cabins	○	○	3.750,00 €	<input type="checkbox"/>
Cold foam mattress with memory top for all berths 5 cabins	○	○	3.980,00 €	<input type="checkbox"/>

INDIVIDUAL OPTIONS		HOLIDAY	STYLE	Price excl. VAT	C50
INTERIOR EQUIPMENT - GALLEY					
STANDARD					
Fridge in galley, 110L, top loading	3 burner stove with oven				
OPTIONS					
Microwave, 230 V	○	○	780,00 €	<input type="checkbox"/>	
Microwave preparation, 110V	○	○	410,00 €	<input type="checkbox"/>	
Dishwasher drawer 230 V	○	○	3.740,00 €	<input type="checkbox"/>	
Additional drawer fridge incl. Freezer unit totalling 160 L	○	○	3.660,00 €	<input type="checkbox"/>	
Extractor hood in galley	—	○	880,00 €	<input type="checkbox"/>	SP
INTERIOR EQUIPMENT - ELECTRICAL SYSTEM					
STANDARD					
Country version EU	Service battery, 2 x 95 Ah / 12 V, AGM				
230 V socket in each cabin	Battery charger, 40 Ah (3 channels)				
Engine battery, 1 x 96 Ah / 12 V, AGM					
OPTIONS					
Inverter 2.500 W, 230 V (true sine wave)	○	○	3.180,00 €	<input type="checkbox"/>	
Inverter 2.000 W, 110 V (true sine wave)	○	○	3.180,00 €	<input type="checkbox"/>	
Diesel generator 6.4 kW, 230 V	○	○	23.740,00 €	<input type="checkbox"/>	
Diesel generator 6.4 kW, 110 V	○	○	28.190,00 €	<input type="checkbox"/>	
Shore power 110 V	○	○	3.910,00 €	<input type="checkbox"/>	
INTERIOR EQUIPMENT - WATER					
STANDARD					
40 L boiler	Electric and manual bilge pump				
70 L holding tank, per toilet					
OPTIONS					
Fresh water dockside inlet	○	○	560,00 €	<input type="checkbox"/>	
Washing machine, 220 V (only with D3 layout)	—	○	3.120,00 €	<input type="checkbox"/>	
Electric toilet (1x) front cabin with fresh water flush system for B1 layout	○	○	1.250,00 €	<input type="checkbox"/>	
Electric toilet (2x) front cabin with fresh water flush system for B2 layout	○	○	2.490,00 €	<input type="checkbox"/>	
Electric toilet (2x) aft cabin with fresh water flush system for D1 or D3 layout	○	○	2.490,00 €	<input type="checkbox"/>	
Electric toilet (1x) aft cabin with fresh water flush system for D2 layout	○	○	1.250,00 €	<input type="checkbox"/>	
Grey water system, totalling 244 L	○	○	2.440,00 €	<input type="checkbox"/>	
INTERIOR EQUIPMENT - CLIMATE CONTROL (HEATING AND AIR CONDITIONER ARE NOT COMBINABLE)					
OPTIONS					
Air Conditioner, Reverse Cycle, 18.000 BTU, 2 Units for foreship cabin and aft cabins, incl. 2nd shore power, 230V / 110V	○	○	17.100,00 €	<input type="checkbox"/>	
Air Conditioner, Reverse Cycle, 16.000 BTU, 1 Unit for salon (incl. D2 cabin), incl. 2nd shore power, 230V / 110V	○	○	13.100,00 €	<input type="checkbox"/>	
Hot air heating, 8,0 kW, 2 Units for salon, foreship cabin(s) and aft cabins	○	○	9.060,00 €	<input type="checkbox"/>	
SHIPMENT					
OPTIONS					
Keel not mounted	○	○	630,00 €	<input type="checkbox"/>	
Steel cradle for oversea transport	○	○	5.530,00 €	<input type="checkbox"/>	
Steel cradle for oversea transport without keel (only with keel not mounted)	○	○	8.080,00 €	<input type="checkbox"/>	
Shrink wrap	○	○	1.300,00 €	<input type="checkbox"/>	

— Not available ■ Standard ○ Optional

Bavaria Yachtbau GmbH, Bavariastraße 1, D-97232 Giebelstadt, Phone +49 9334 942-0, Fax +49 9334 942-1160, www.bavariayachts.com, info@bavariayachts.com

All prices are in EURO and are valid only in conjunction and at the time of ordering a new yacht ex works Giebelstadt. All measurements and weights are calculations based upon design documents. The brochure is intended for advertisement only and is not part of a contract, warranty or of any offer. We reserve the right to modify or improve our products and to change specifications without notice. We reserve the right to replace the brands/manufacturers mentioned in the price list with equivalent products from other reputable manufacturers. We are not liable for errors and printing mistakes. Aforementioned prices are recommended sales prices for deliveries ex works within 4 months of order placement. Later deliveries are subject to invoicing according to the then valid price list.

Version: 2/2023

Valid from 15th December 2022

Publication: 15th December 2022 – The previous price list loses its validity.

Language/Taxes: English pricelist/all prices excl. VAT

